

Geo.Prince Takeshita Co.,Ltd.

Metal Fittings installed to covers for water treatment plants and facilities

- High corrosion-resistant fittings produced for water treatment plants and water storage tanks.

H-143K-SUS Features

Item name : Stainless Flat Pulls (with Lock)

- Flat pulls installed to covers for water treatment plants and water storage tanks.
- Heat/corrosion-resistant.
- Flat design with few projections from the surface.

Specifications (Technical principle, Function)

• Material : Stainless Steel Sheet Finish : Hairline Buffing

- Unable to lock/unlock with coins for prevention.
Use exclusive handle to lock. (Handle for H-143K-SUS)
- With drain hole.



Installation image

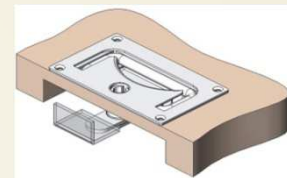

H-144-SUS Features

Item name : Stainless Hatch Pulls with Plate

- Flat pulls installed to covers for water treatment plants and water storage tanks.
- Heat/corrosion-resistant.
- Flat design with few projections from the surface.

Specifications (Technical principle, Function)

• Material : Stainless Steel Finish : Electrolytic Polishing

- By adding the stainless cap for pull, handle can be pulled up even if the thickness of the plate is 50mm or 75mm.



L-582-SUS Features

Item name : Stainless Embedded Locks

- Locks installed to covers for water treatment plants and water storage tanks.
- Heat/corrosion-resistant.
- Easy installation with flat shape.

Specifications (Technical principle, Function)

• Material : Stainless Steel Finish : Hairline Buffing

- Unable to lock/unlock with coins for prevention.
Use exclusive handle to lock. (Handle for H-143K-SUS)



Installation image

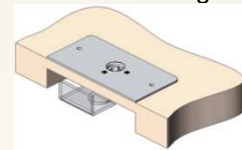

L-584-SUS Features

Item name : Stainless Bolt Locks

- Locks installed to covers for water treatment plants and water storage tanks.
- Heat/corrosion-resistant.



Specifications (Technical principle, Function)

- Material : Stainless Steel Sheet Finish : Hairline Buffing
- Unable to lock/unlock with coins for prevention.
Use exclusive handle to lock. (Handle for H-143K-SUS)
- With drain hole.

Installation image

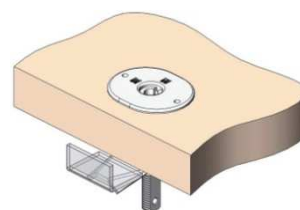

L-585-SUS Features

Item name : Stainless Stopper Plates

- Stopper plates installed to covers for water treatment plants and water storage tanks.
- Heat/corrosion-resistant.



Specifications (Technical principle, Function)

- Material : Stainless Steel Sheet Finish : Barrel Polishing
- Anchors and nuts are attached.

Installation image

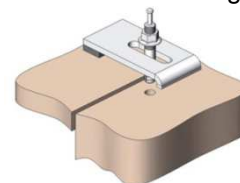

PC-122-SUS Features

Item name : Stainless Sliding Rollers

- Sliding rollers installed to movable covers for water treatment plants and water storage tanks.
- Heat/corrosion-resistant.



Specifications (Technical principle, Function)

- Material : [Frame] Stainless Steel Sheet(SUS-304) [Wheel] Stainless Steel Sheet(SUS-303)
- Equipped with a durable 440C bearing.
- Wheel types: VH type (PC-61-SUS), FLAT type (PC-120-SUS), V type (PC-121-SUS), R type (PC-122-SUS).
- Wheel diameters 50 – 200mm are available.
- SUS-304 roller is available.

Geo.Prince Takeshita Co.,Ltd.

Osaka Branch

<http://www.geoprince.co.jp/>

E-mail info@geoprince.co.jp

1-4-32, Honjonishi, Hogashi-Osaka City, Osaka, 578-0965 Japan

TEL +81-6-6747-2591 FAX +81-6-6747-2710